

770

769

768

767

766

765

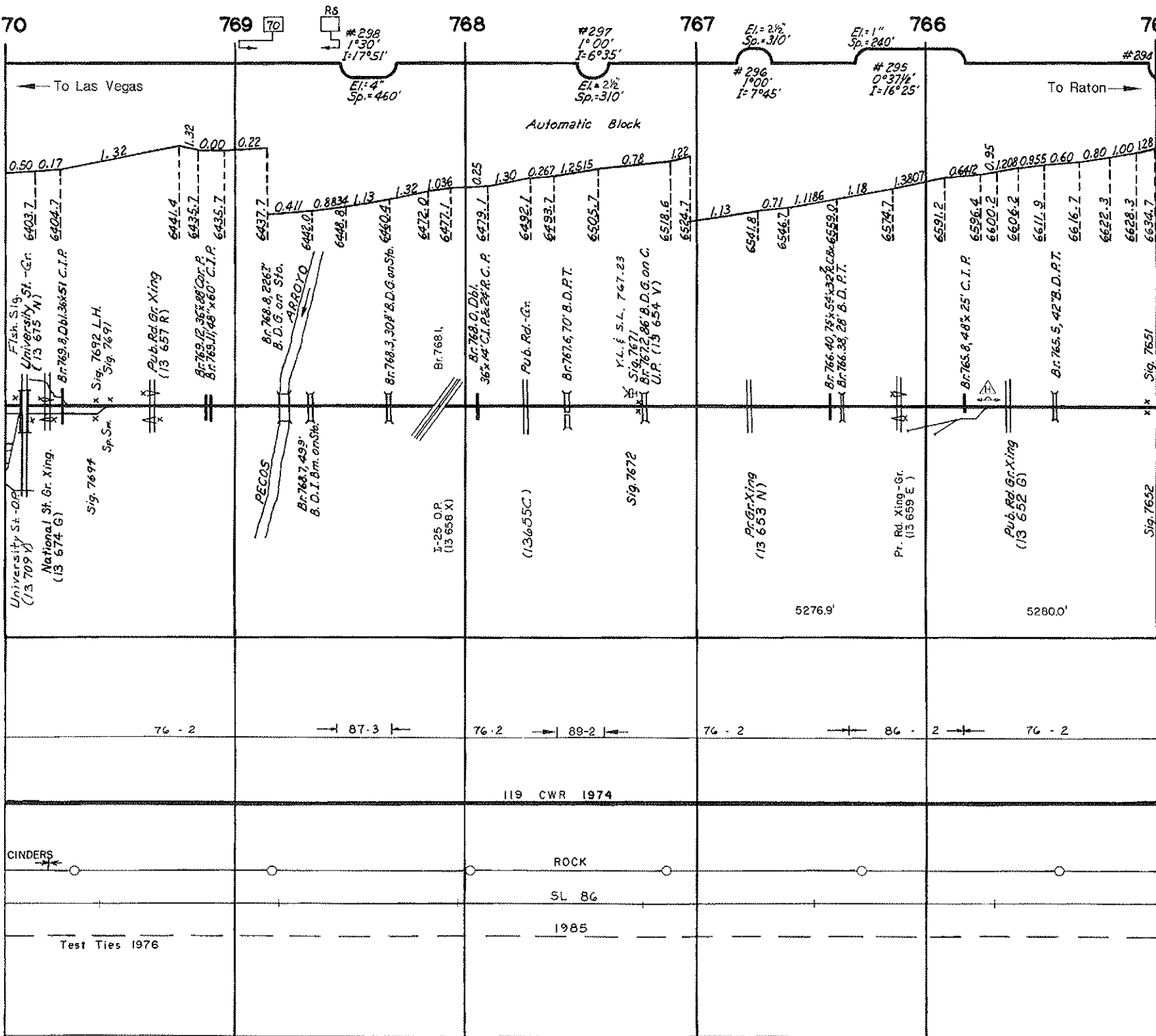

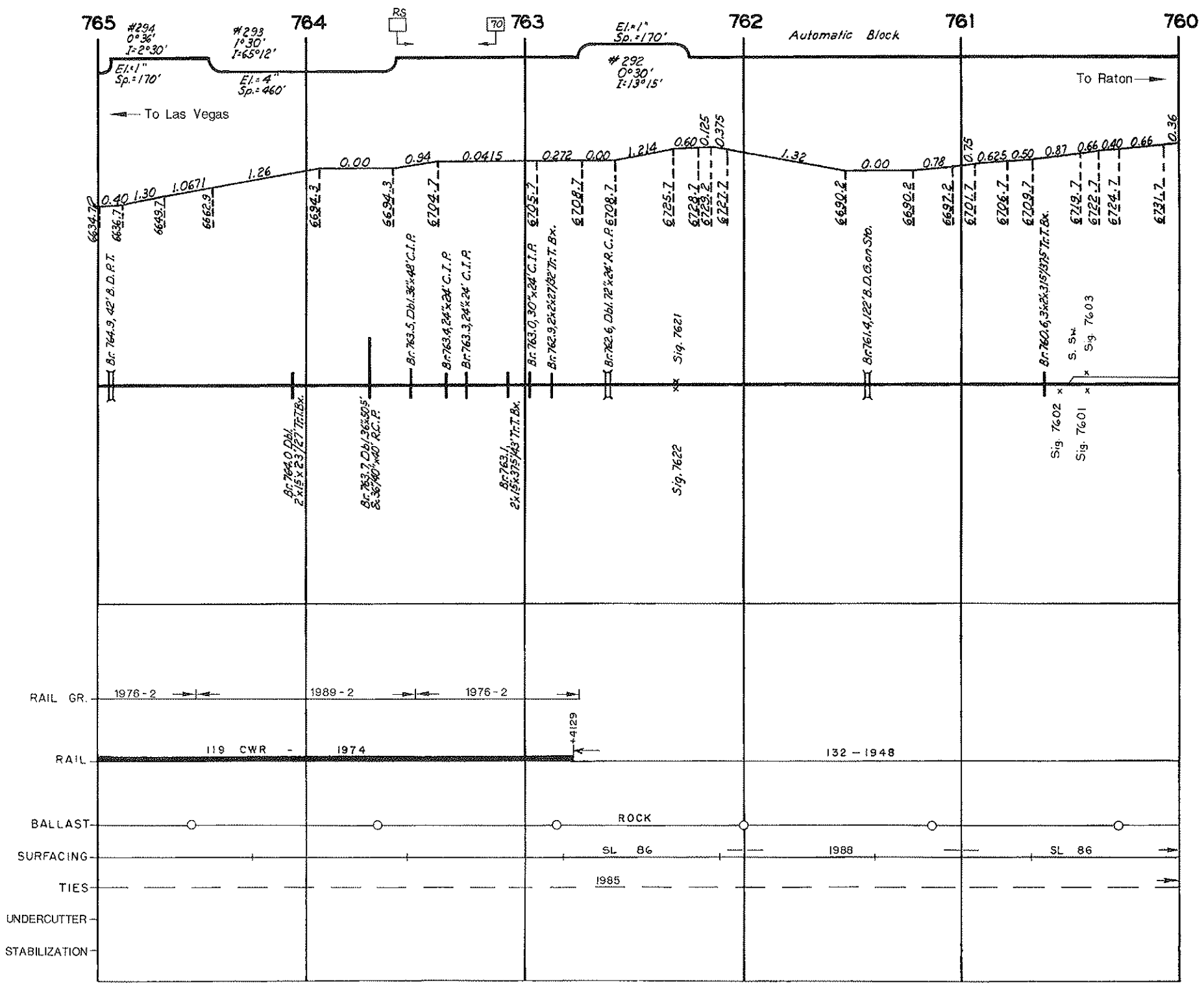

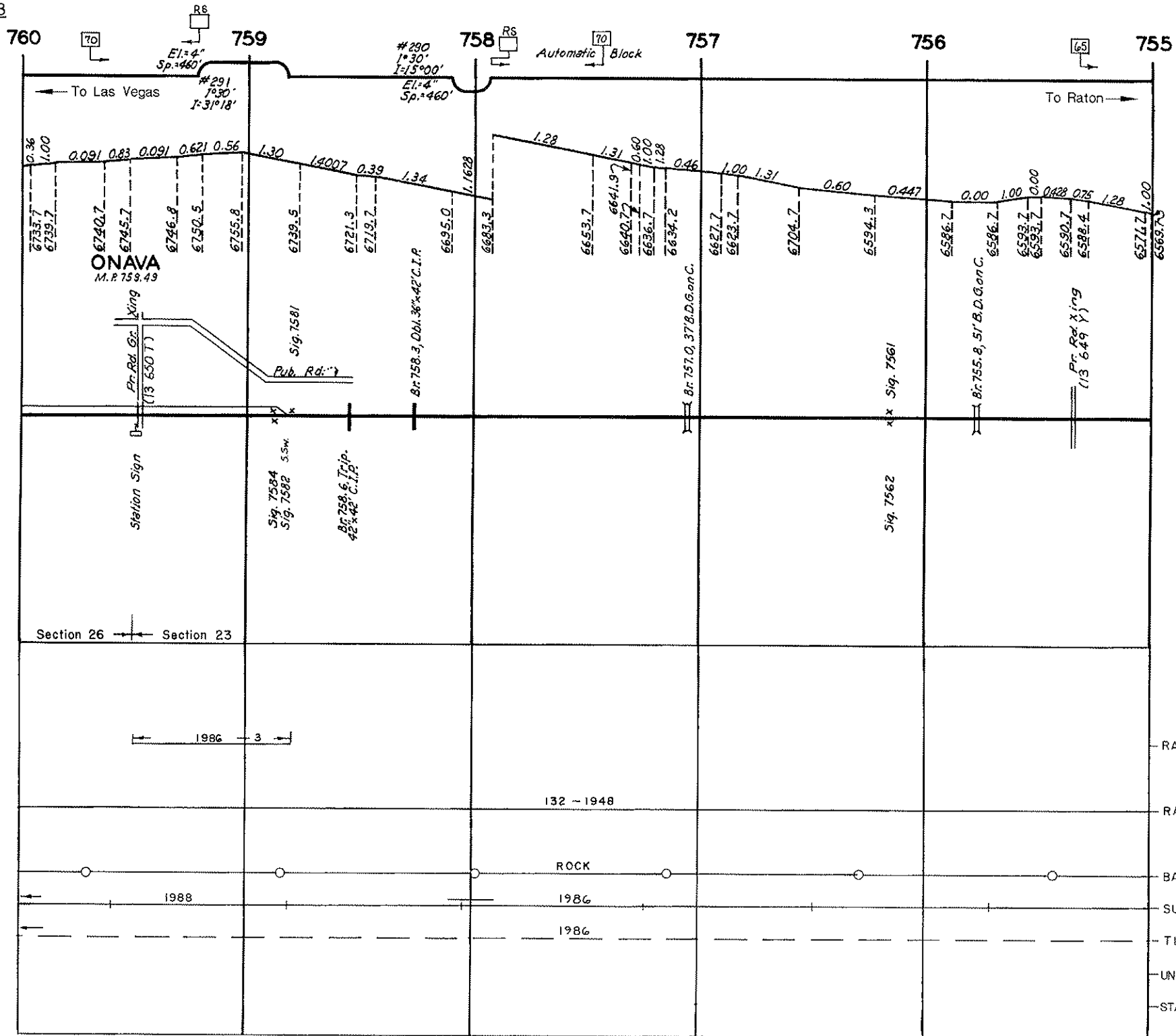

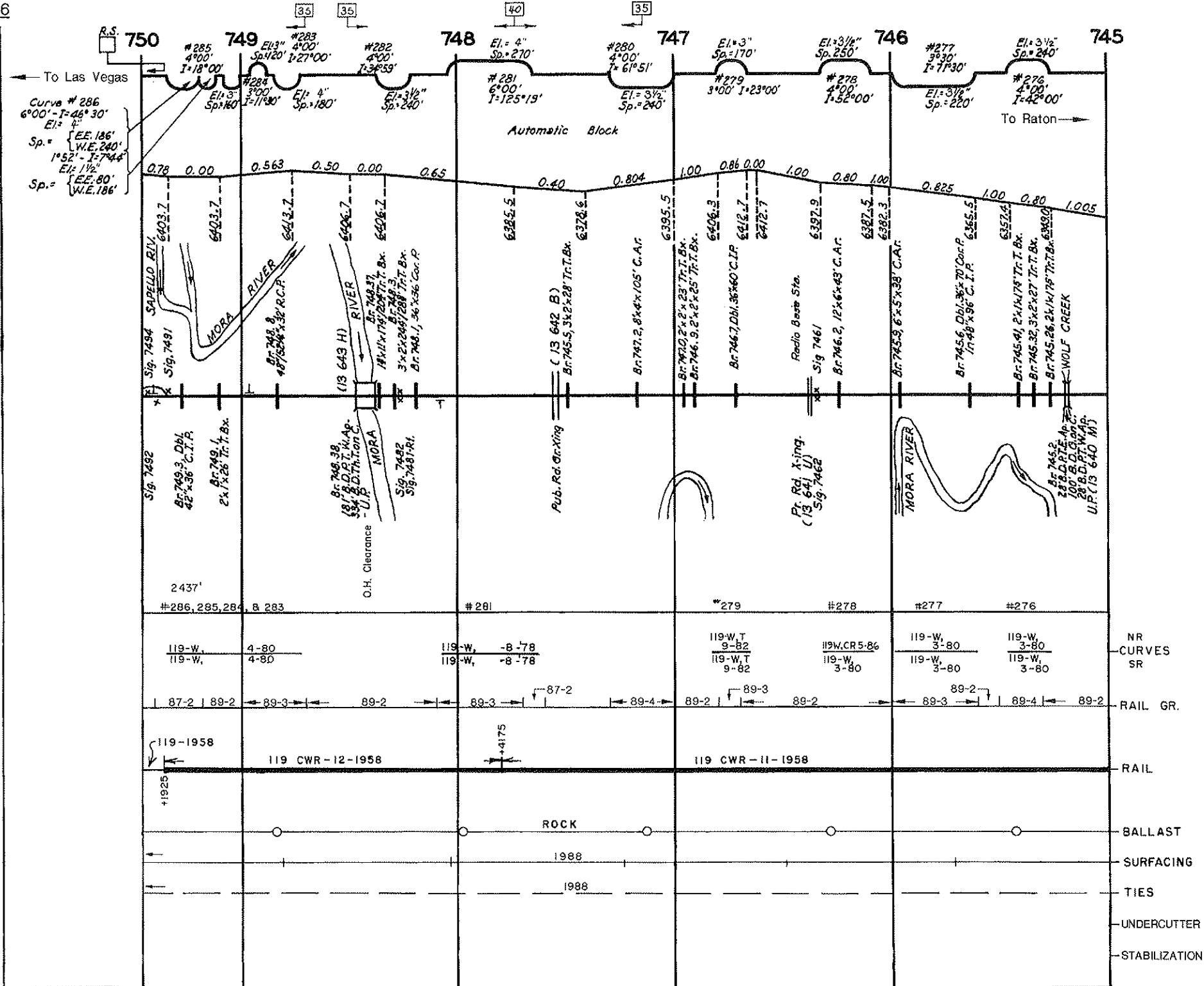

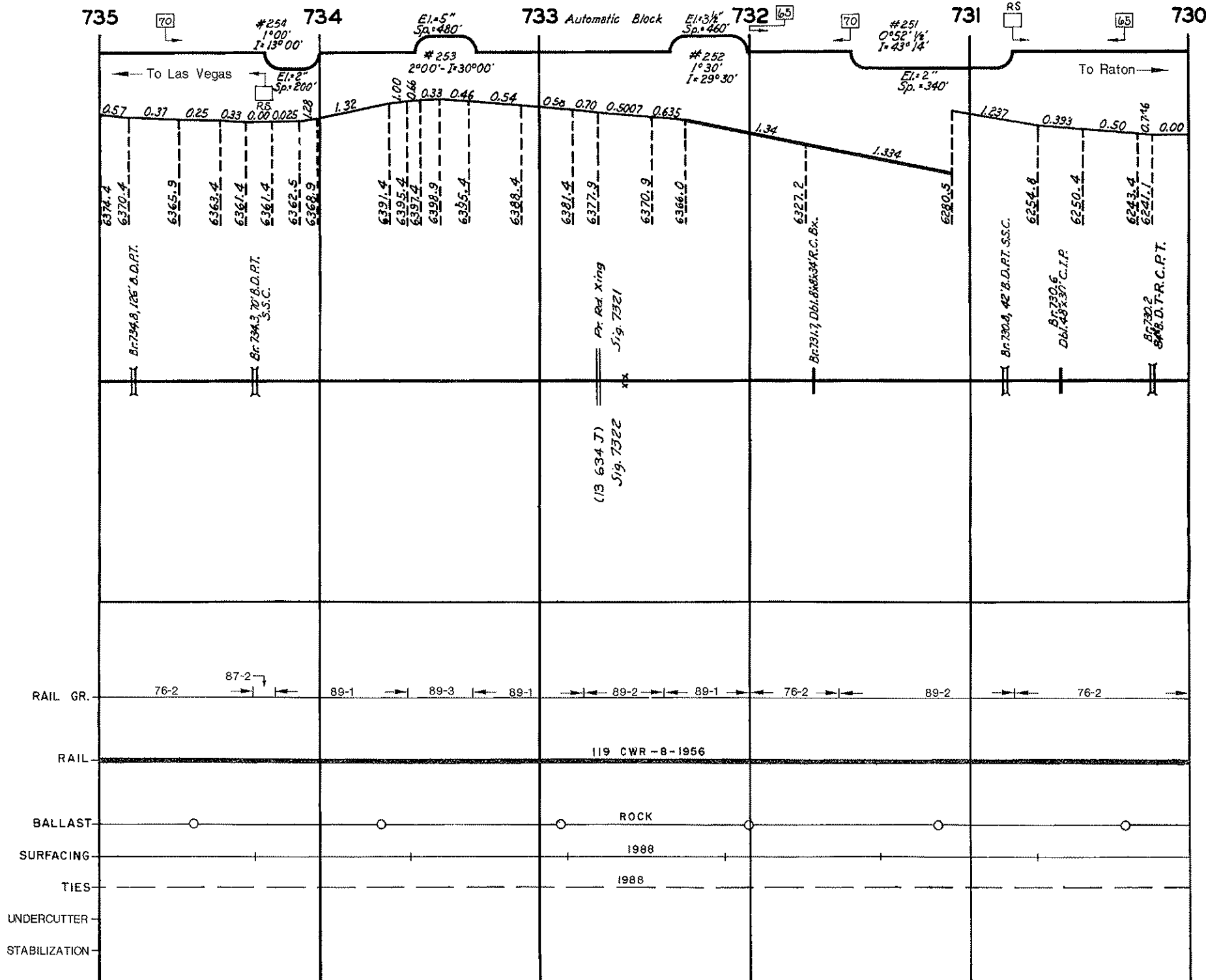

730

729

728

Automatic Block

727

726

725

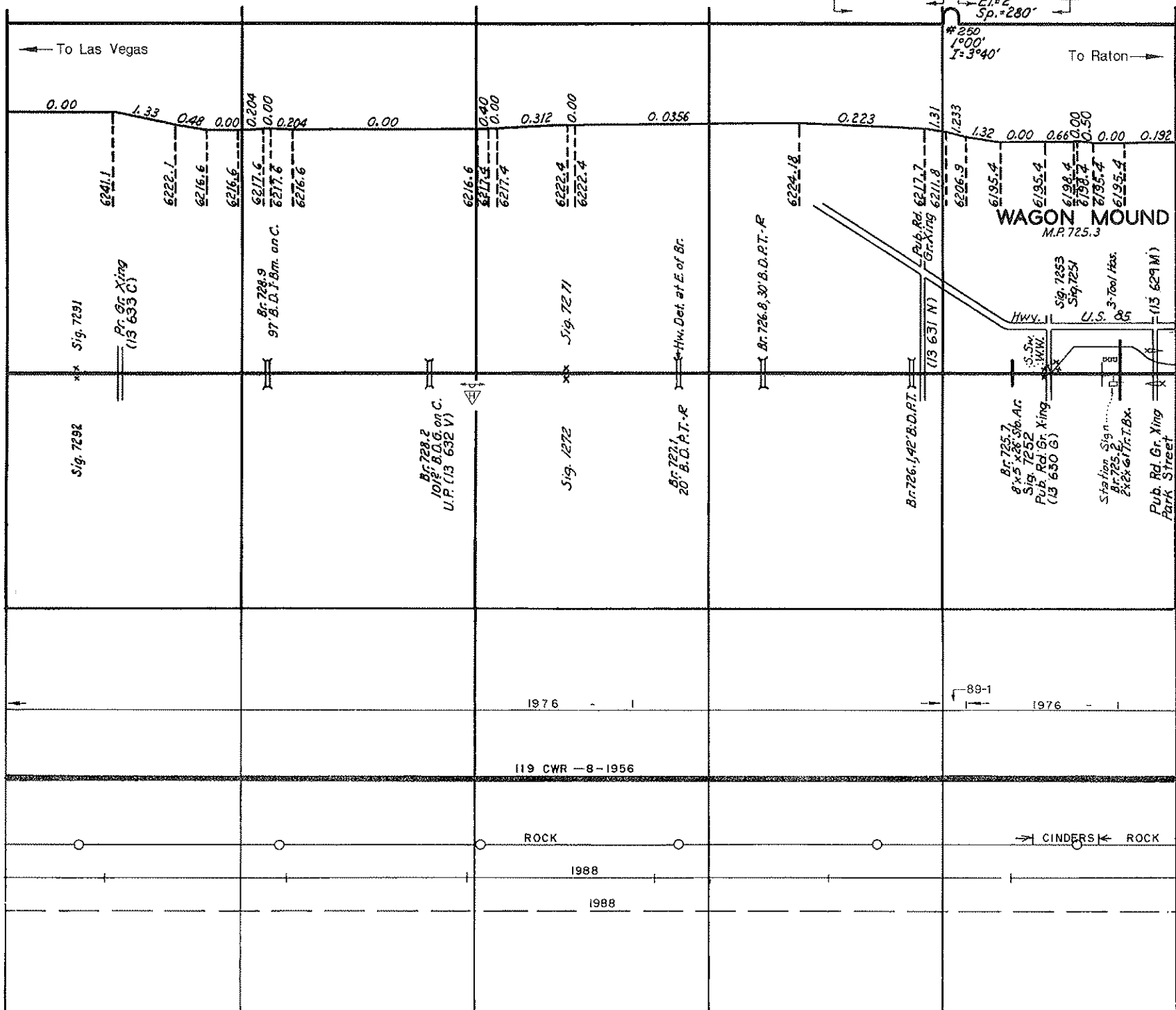

WAGON MOUND
M.P. 725.3

1976

1976

119 CWR - 8 - 1956

ROCK

CINDERS ROCK

1988

1988

RAIL GR.

RAIL

BALLAST

SURFACING

TIES

UNDERCUTTER

STABILIZATION

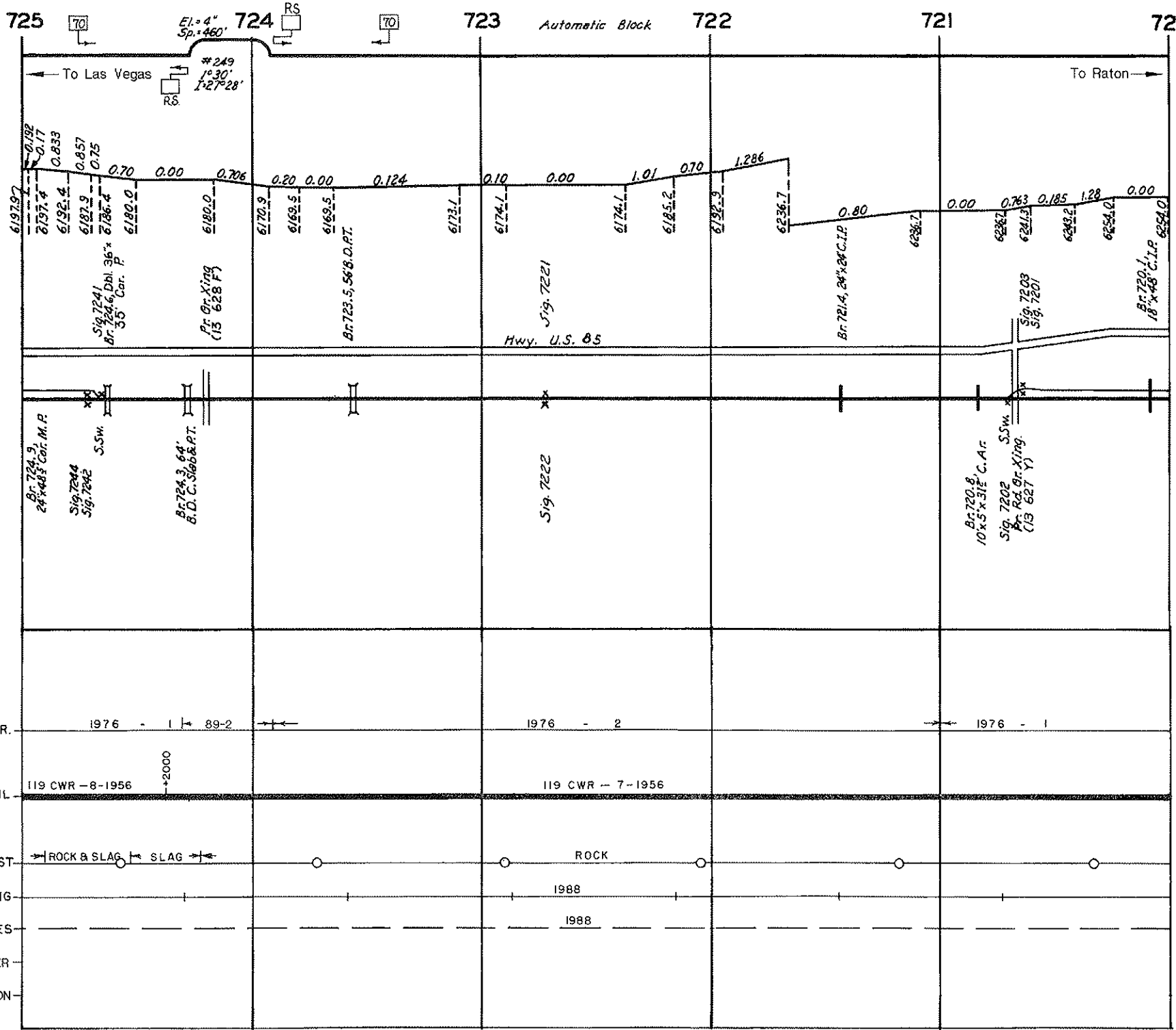

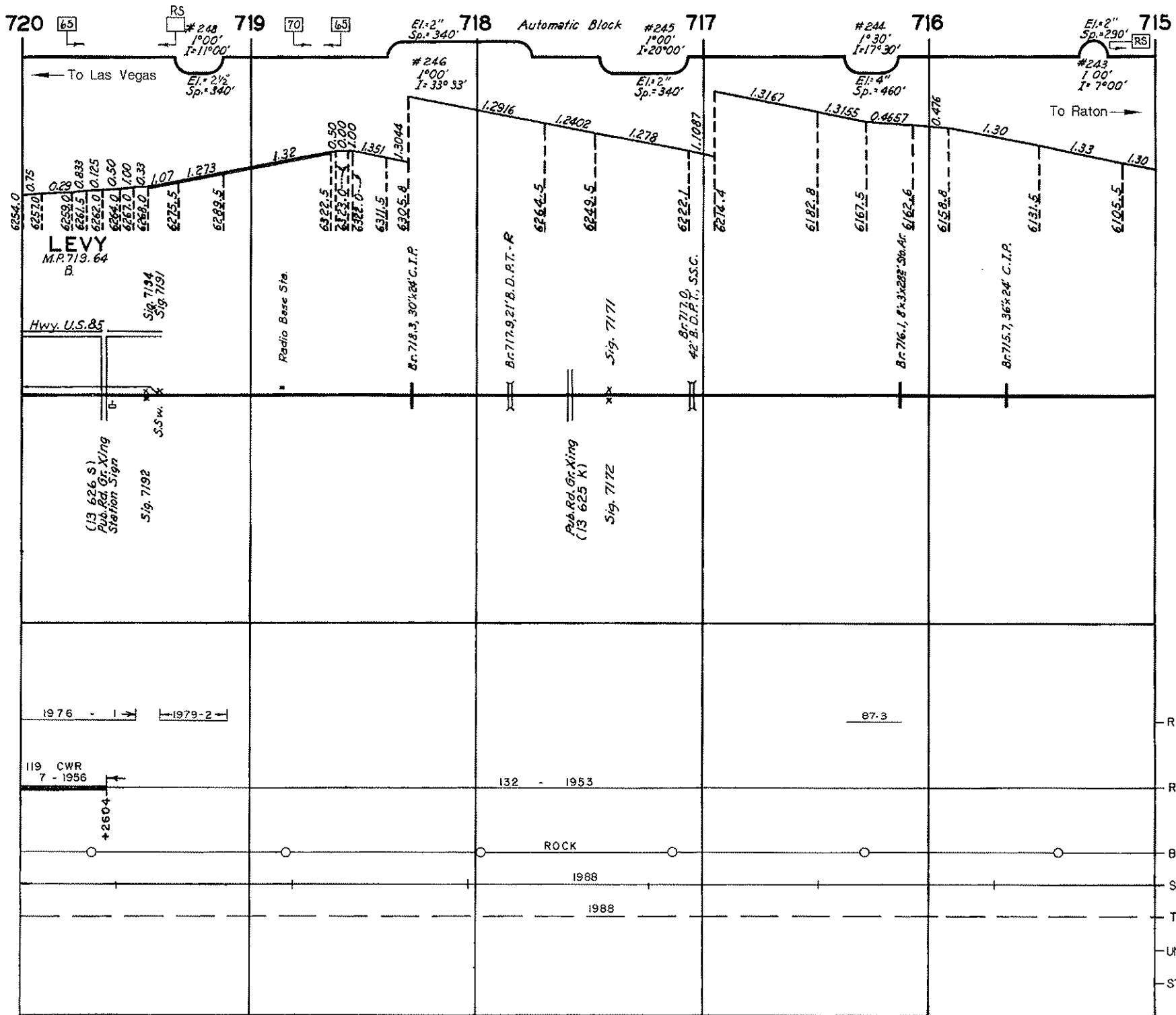

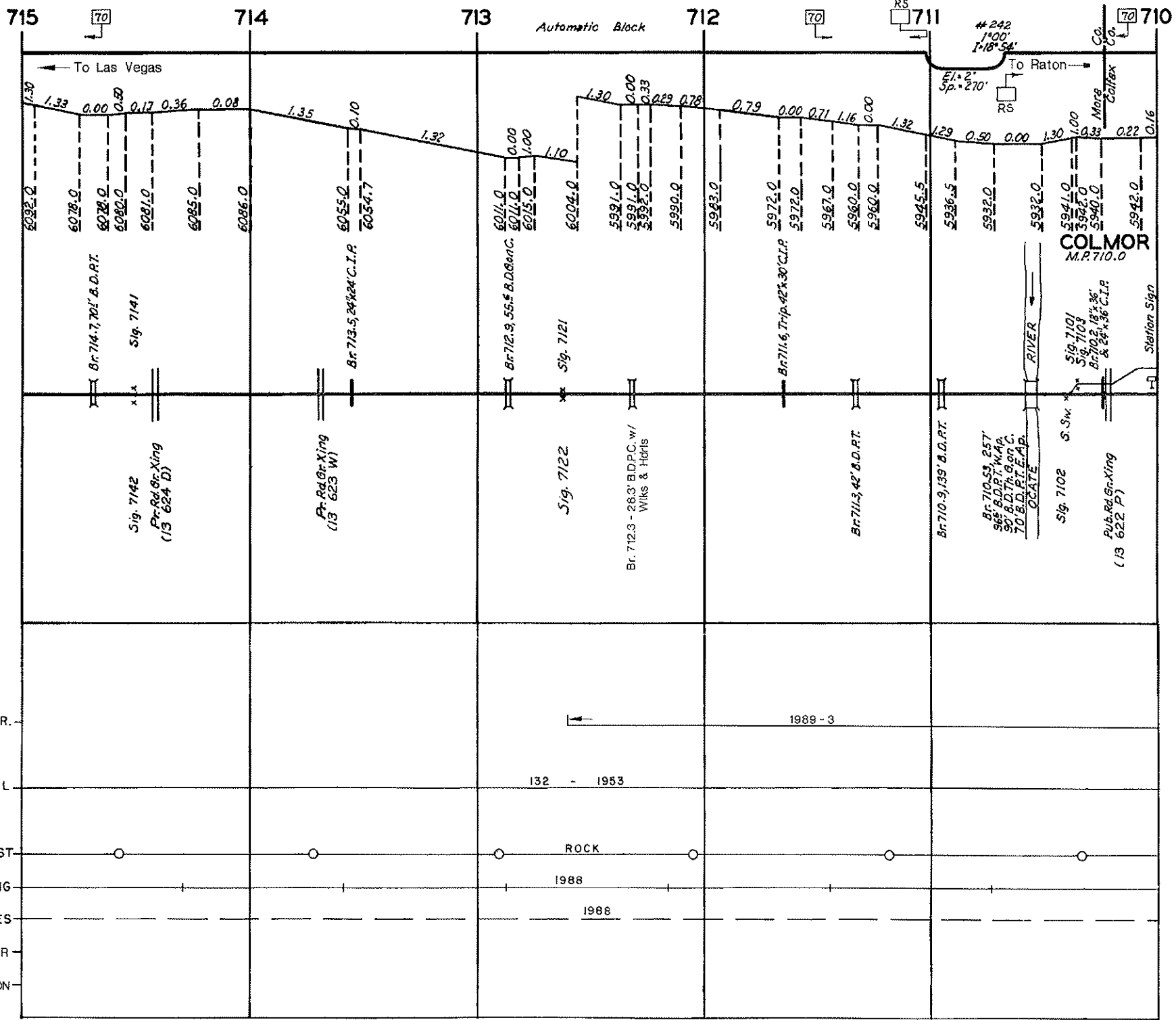

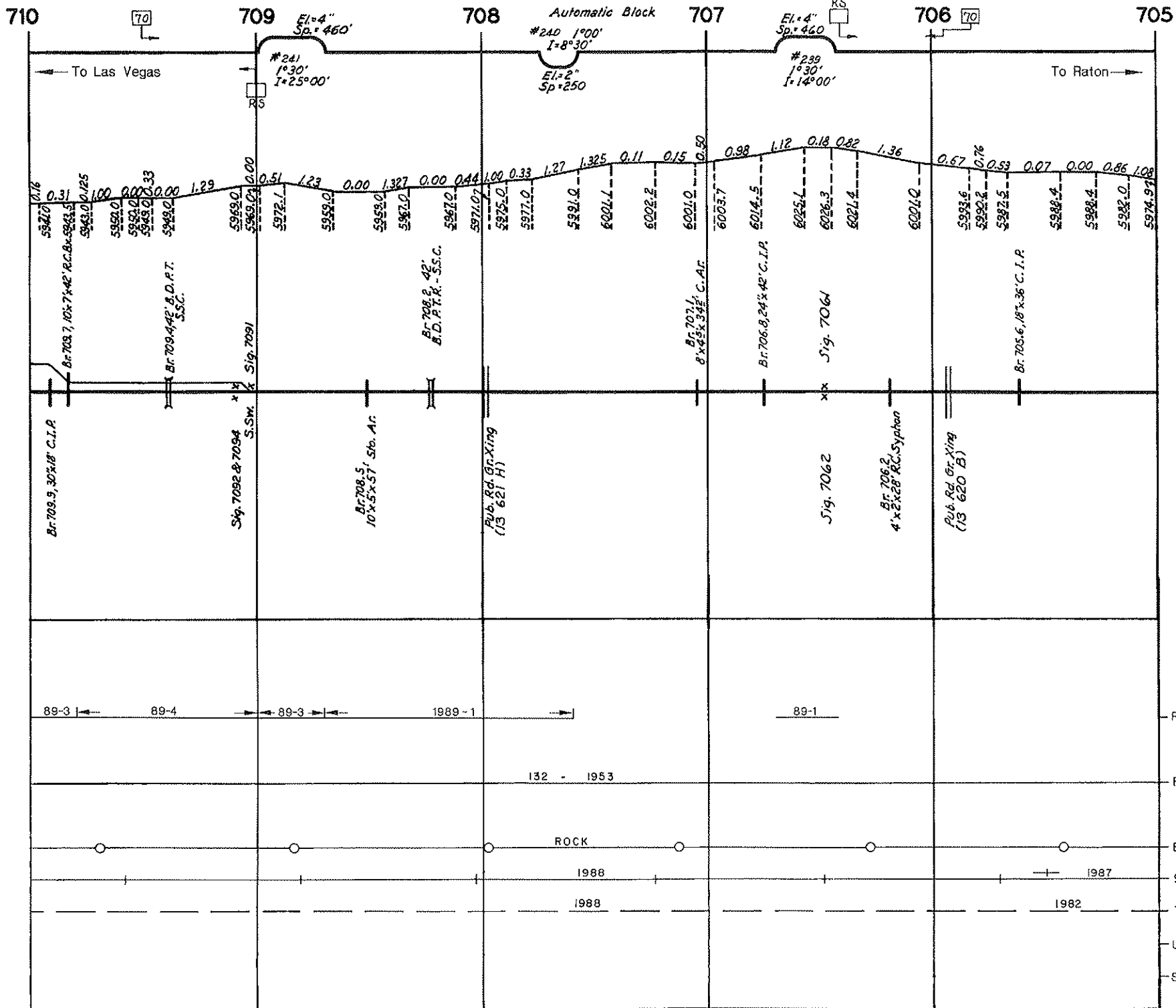

REVISED 1-91

RAIL GR.
 RAIL
 BALLAST
 SURFACING
 TIES
 UNDERCUTTER
 STABILIZATION

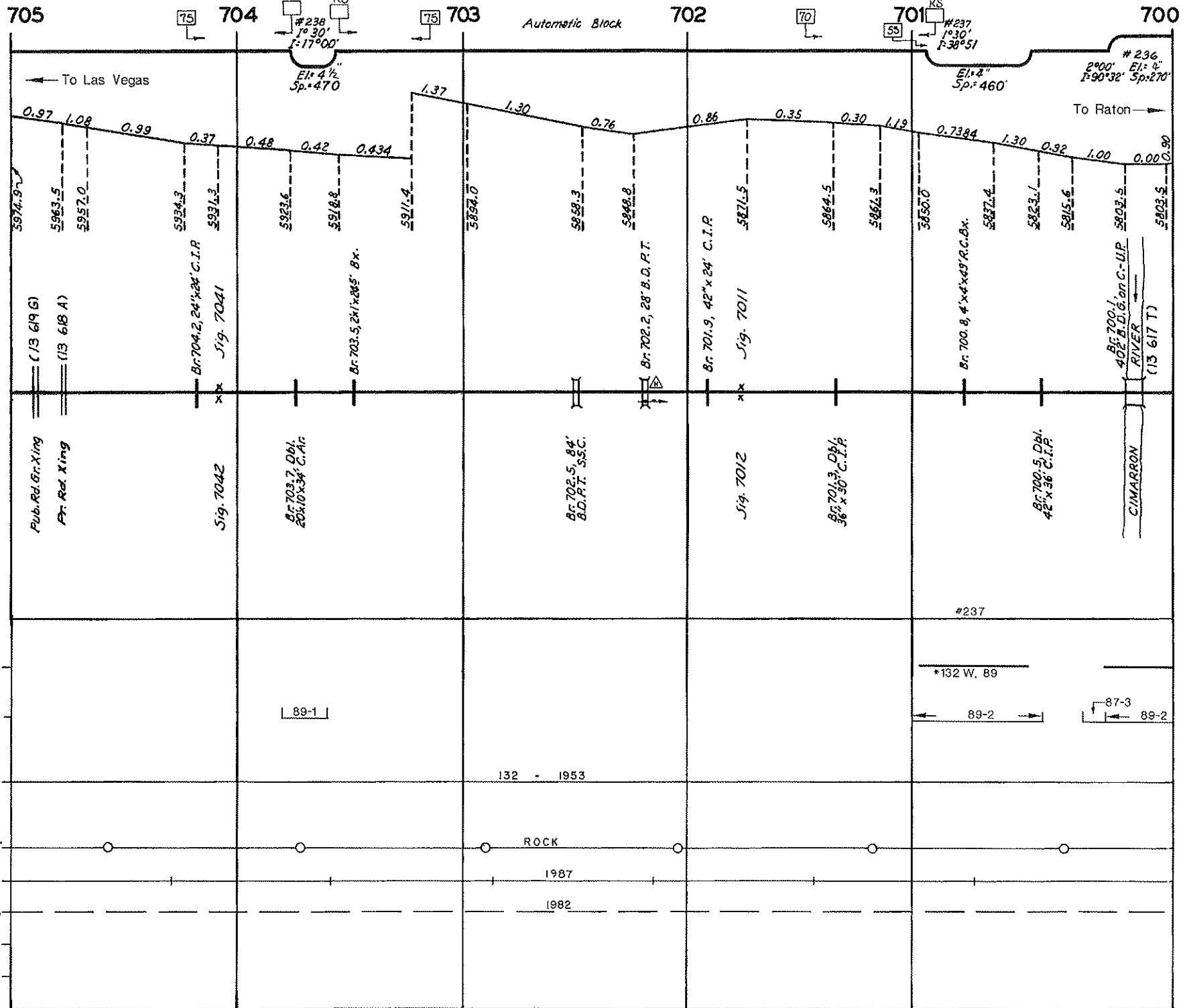

705

704

703

702

701

700

To Las Vegas

Automatic Block

To Raton

0.97 1.08 0.99 0.37 0.48 0.42 0.434 1.37 1.30 0.76 0.86 0.35 0.30 1.19 0.7384 1.30 0.92 1.00 0.00 0.90

5974.97 5963.5 5957.0 5934.3 5934.3 5918.8 5911.4 5894.0 5893.3 5894.8 5871.5 5864.5 5864.3 5850.0 5837.4 5823.1 5815.6 5803.5 5803.5

Pub. Rd. Gr. Xing (13 619 G)
 Pub. Rd. Xing (13 618 A)
 Br 704.2, 24' x 24' C.I.P. Sig. 7041
 Br 703.7, Dbl. 20' x 10' x 34' C.I.P.
 Br 703.5, 24' x 24' Bx.
 Br 702.5, 84' B.D.P.T. S.S.C.
 Br 702.2, 28' B.D.P.T.
 Br 701.9, 42' x 24' C.I.P. Sig. 7011
 Br 700.8, 4' x 4' x 49' R.C.Bx.
 Br 700.5, Dbl. 42' x 36' C.I.P. Sig. 7012
 Br 700.1, Dbl. 40' x 10' x 34' C.I.P. on C.U.P. RIVER (13 617 T)

NR SR CURVES
 RAIL GR.
 RAIL
 BALLAST
 SURFACING
 TIES
 UNDERCUTTER
 STABILIZATION

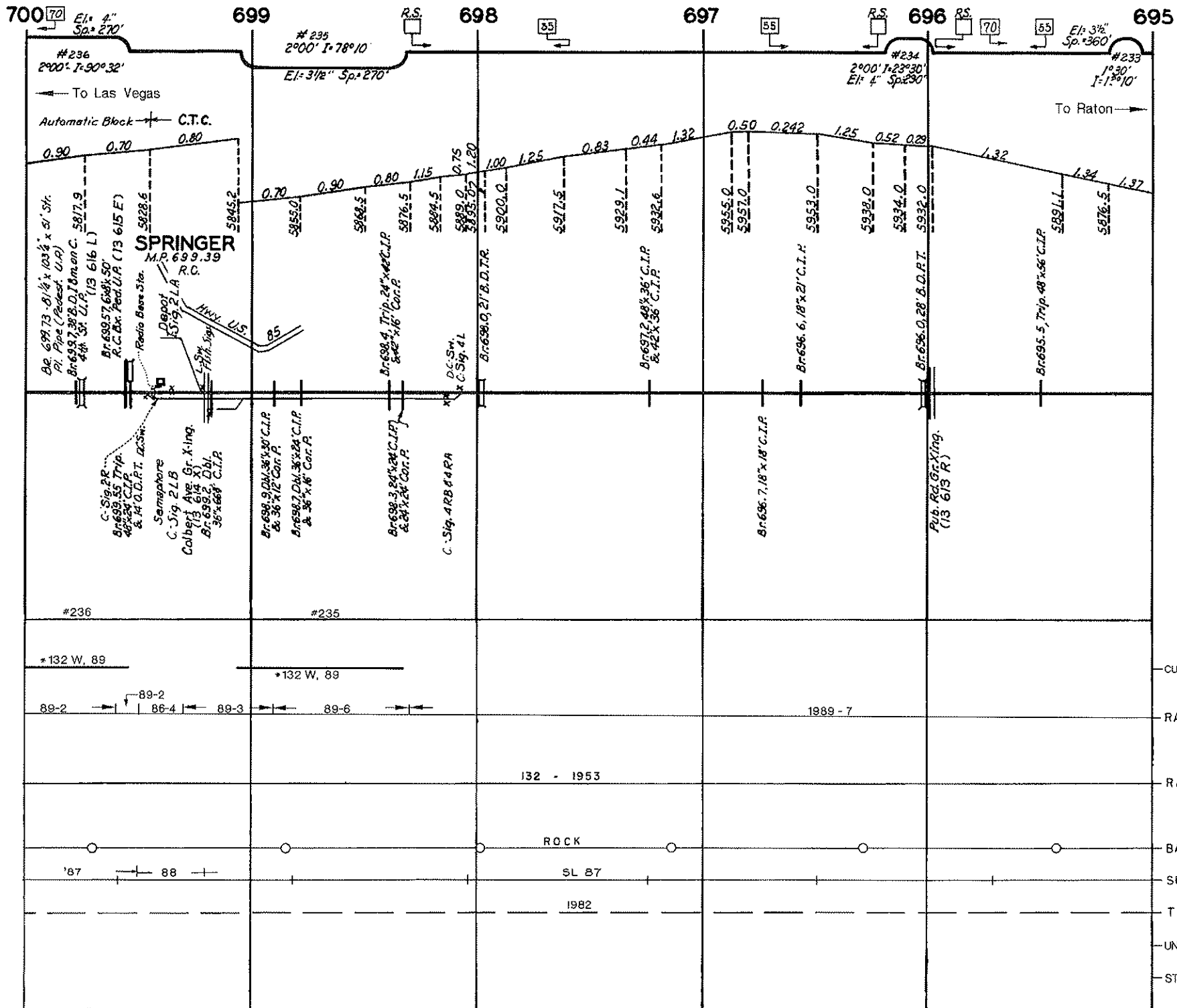

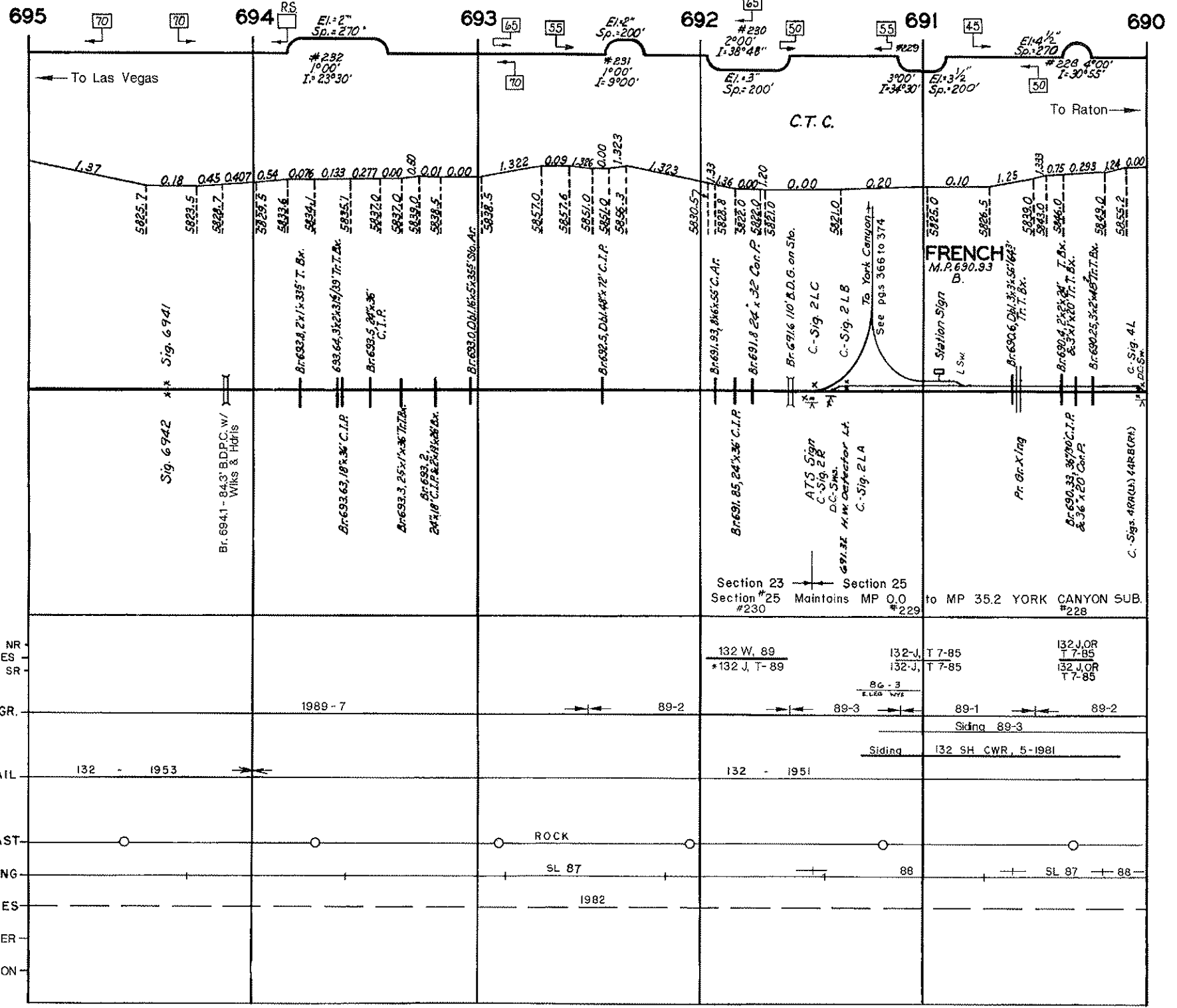

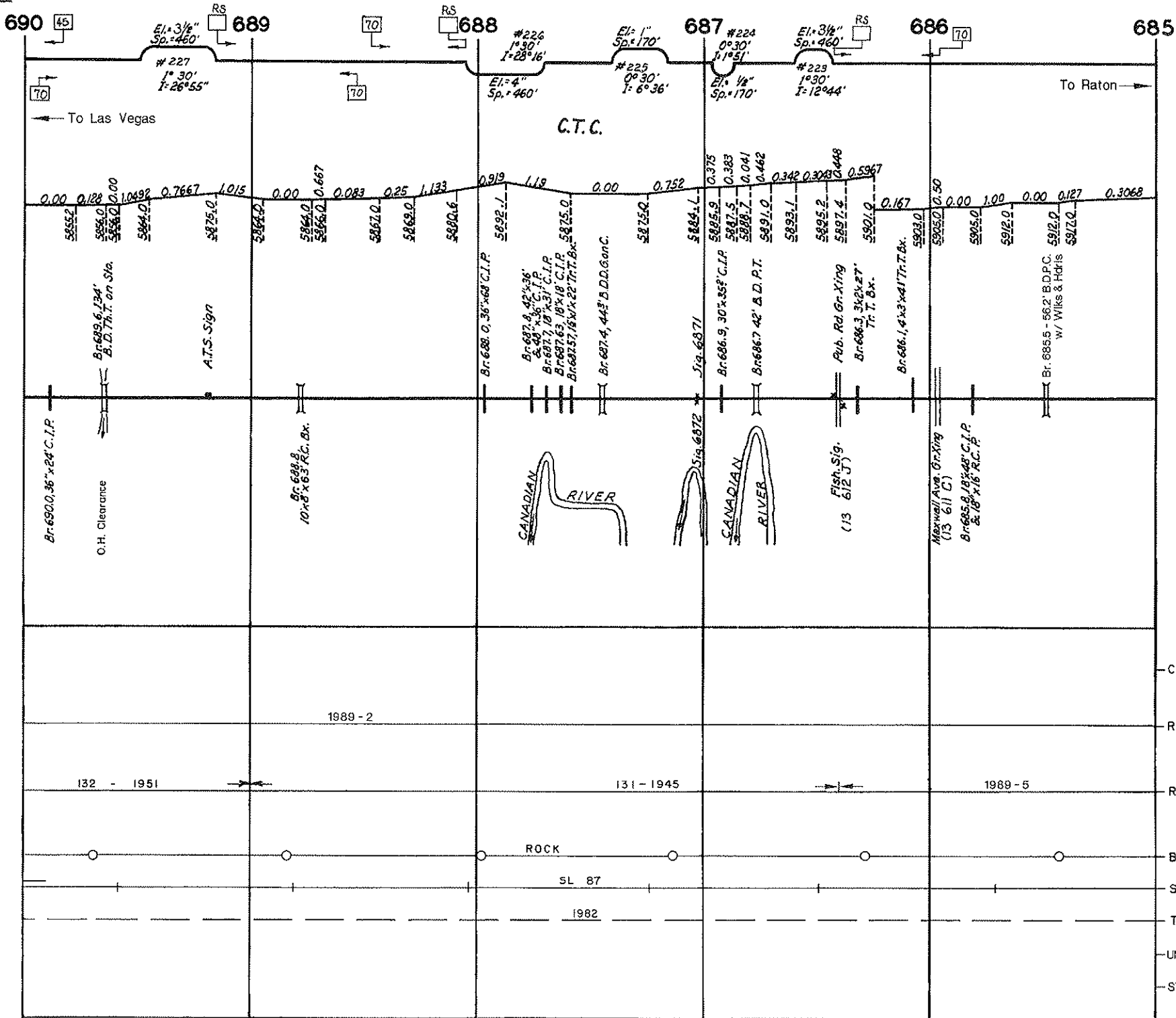

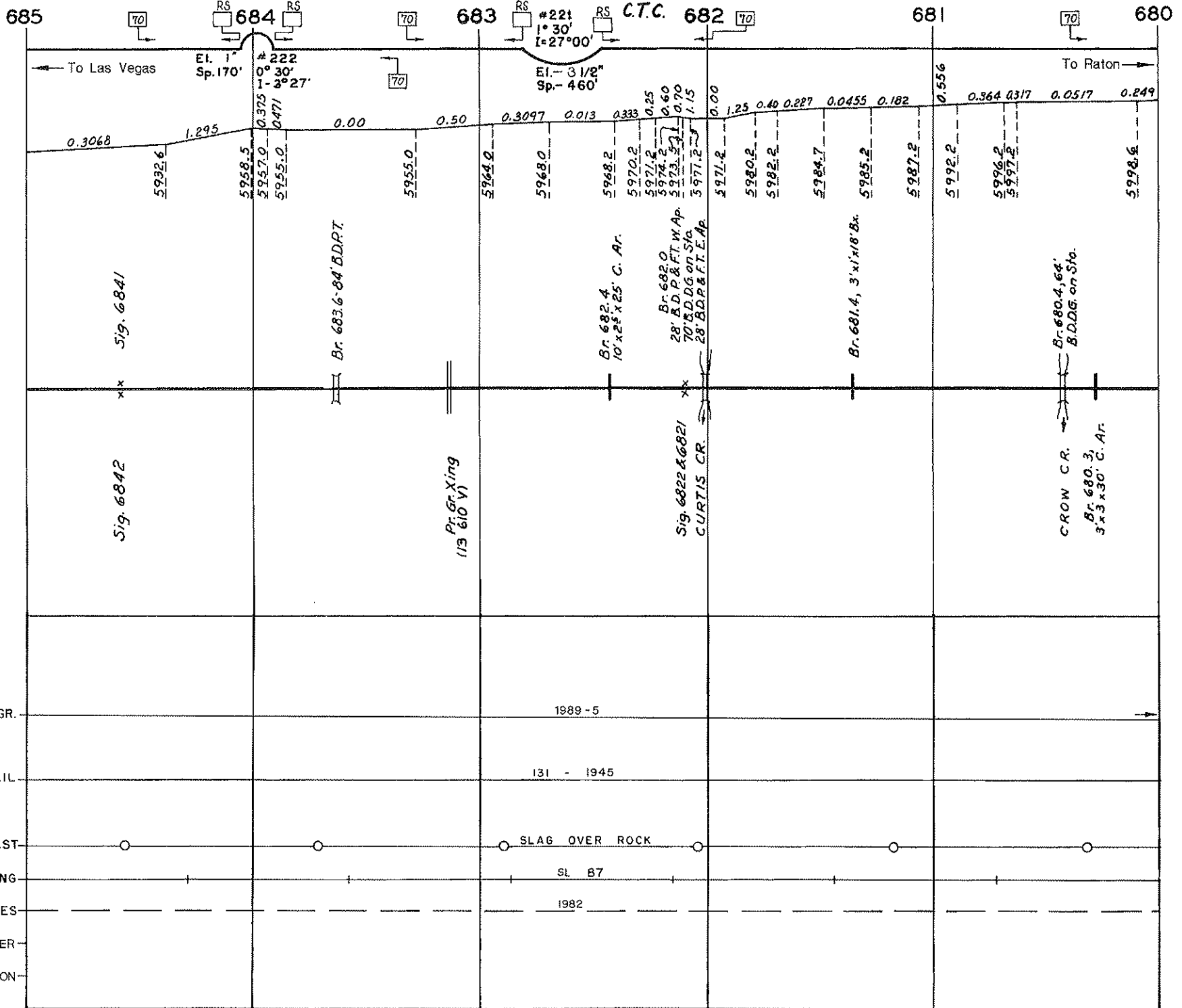

REVISED 1-91

RAIL GR.

RAIL

BALLAST

SURFACING

TIES

UNDERCUTTER

STABILIZATION

1989 - 5

131 - 1945

SLAG OVER ROCK

SL B7

1982

Sig. 6841

Sig. 6842

Pr. Gr. Xing
113 610 V

Br. 682.4
10' x 25' x 25' C. Ar.

Sig. 6822 & 6821
CURTIS CR.

Br. 681.4, 3' x 18' Bx.

CROW C.R.
Br. 680.3
3' x 30' C. Ar.

685

684

683

C.T.C.

682

681

680

To Las Vegas

To Raton

El. 1" Sp. 170'

El. - 3 1/2" Sp. - 460'

0.3068

1.295

0.375

0.471

0.00

0.50

0.3097

0.013

0.333

0.25

0.60

0.70

1.15

0.00

1.25

0.40

0.227

0.0455

0.182

0.556

0.364

0.317

0.0517

0.249

5992.6

5958.5

5957.0

5955.0

5955.0

5964.2

5968.0

5968.2

5970.2

5971.2

5974.2

5973.531

5971.2

5971.2

5980.2

5982.2

5984.7

5985.2

5987.2

5992.2

5996.2

5997.2

5998.6

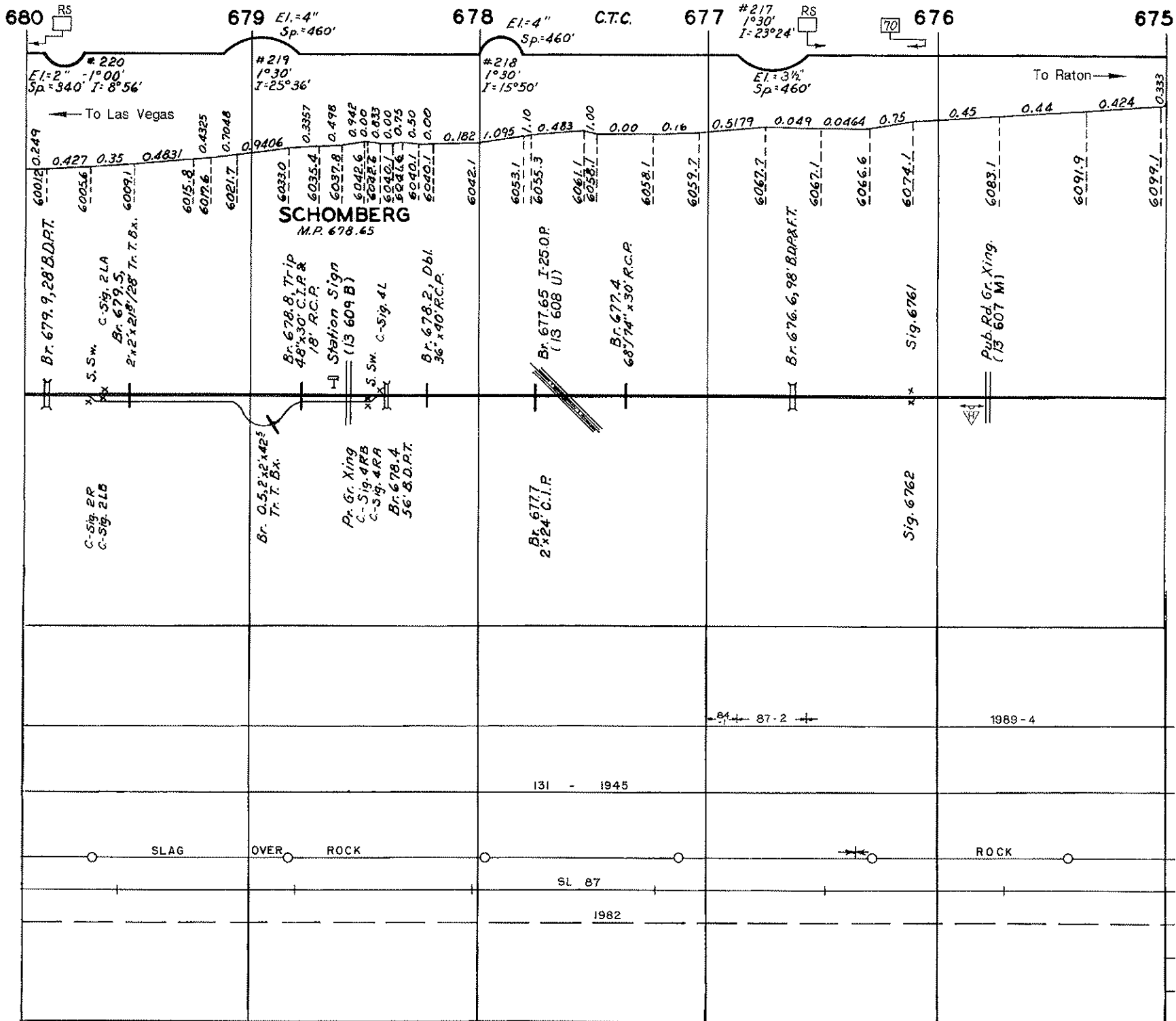

SCHOMBERG
M.P. 678.65

Pa. Gr. Xing
C-Sig. 4RB
C-Sig. 4RA
Br. 678.4
56' S.D.P.T.

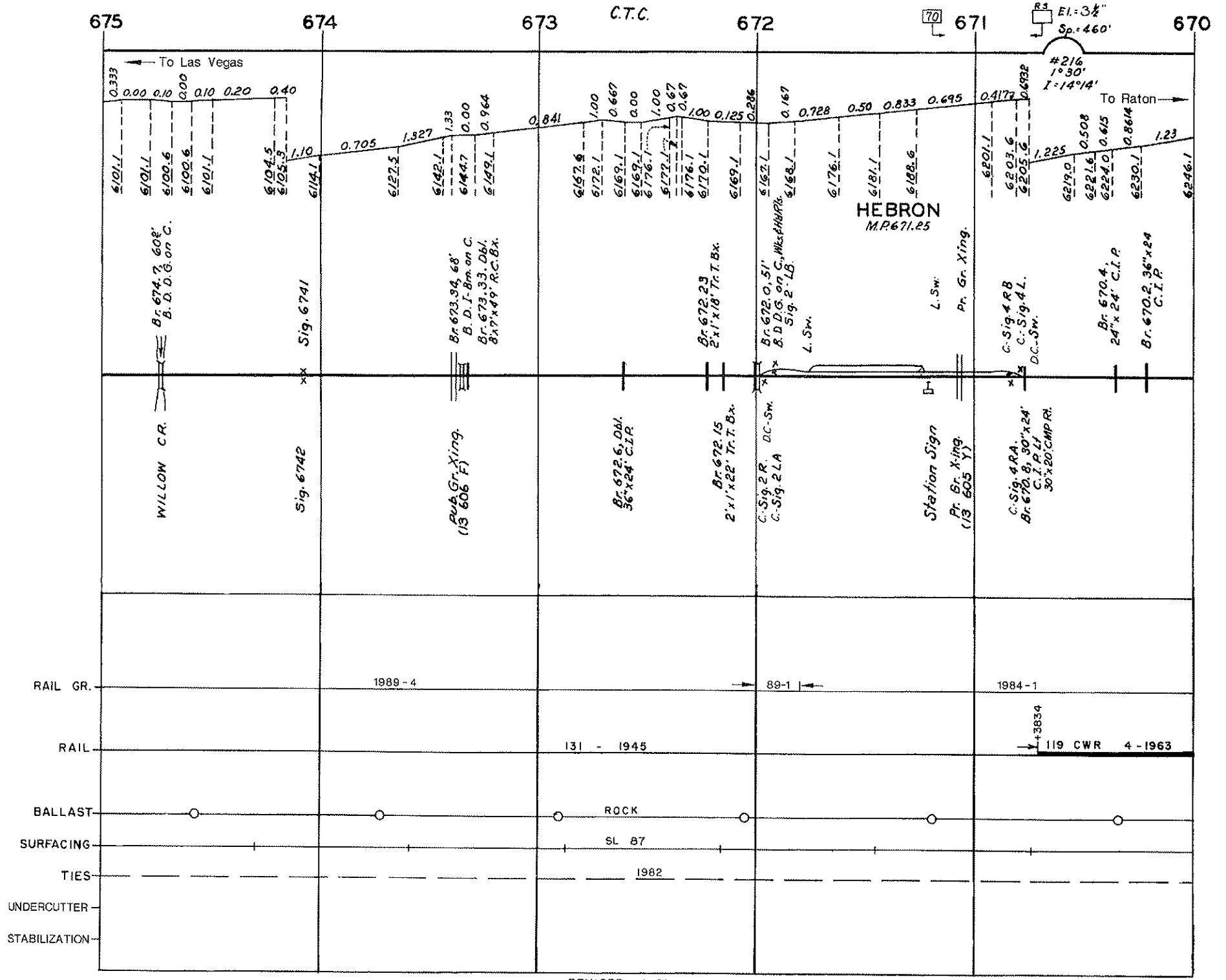

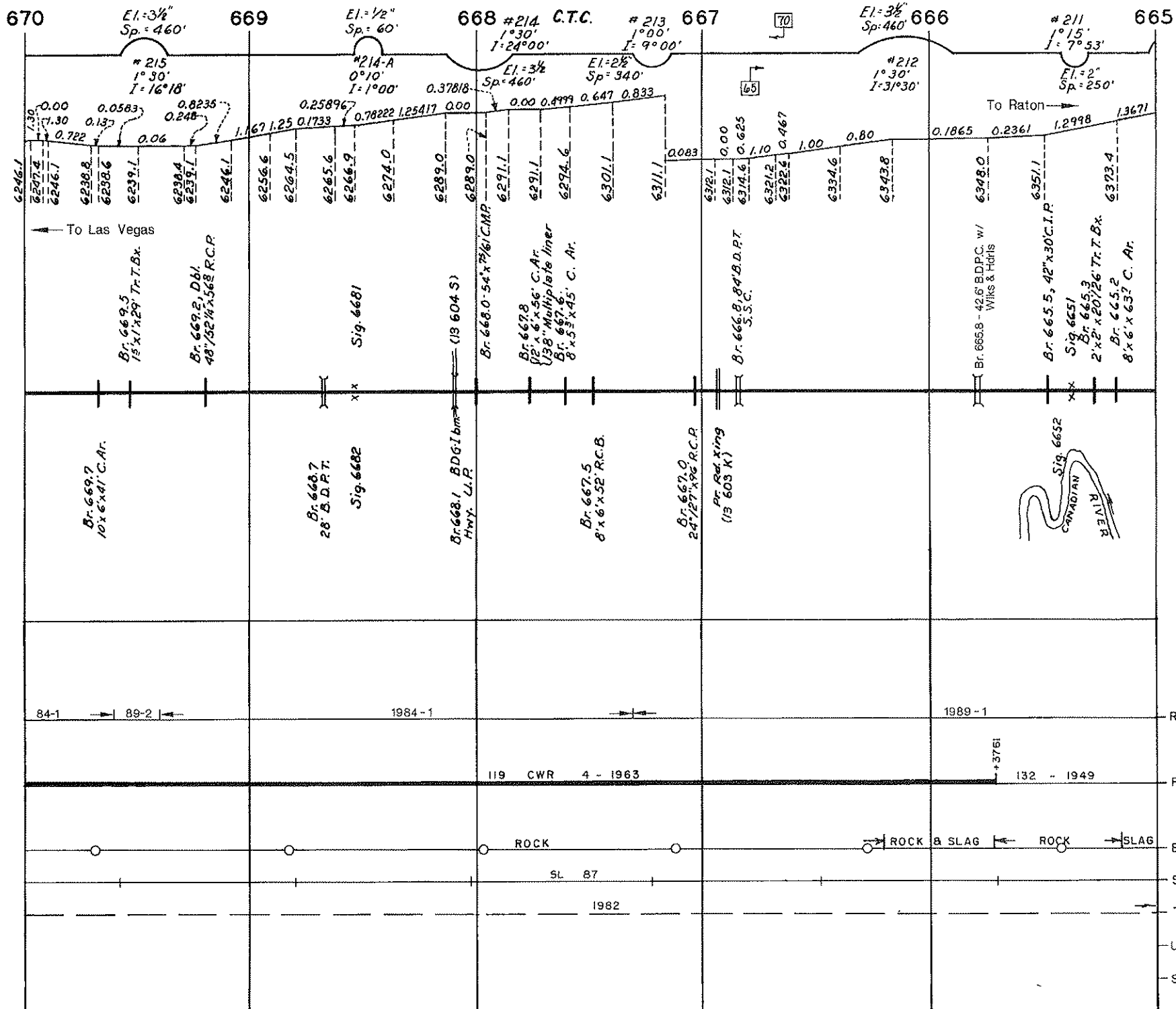

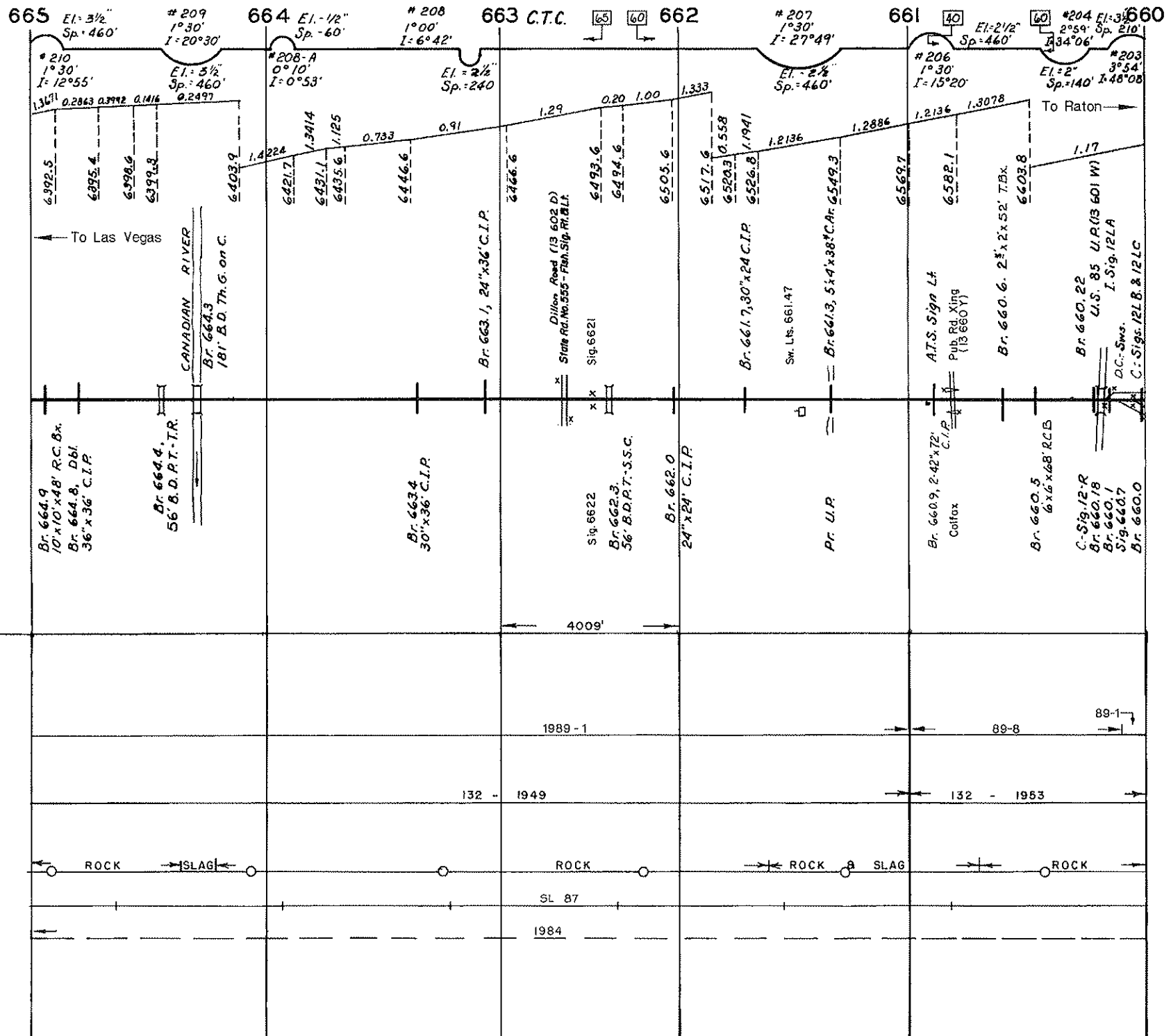

Las Vegas Subdivision

Raton (M.P. 659.1) to Las Vegas (M.P. 769.0)